

# Bearing Assemblies

## Steel design

Type LVA

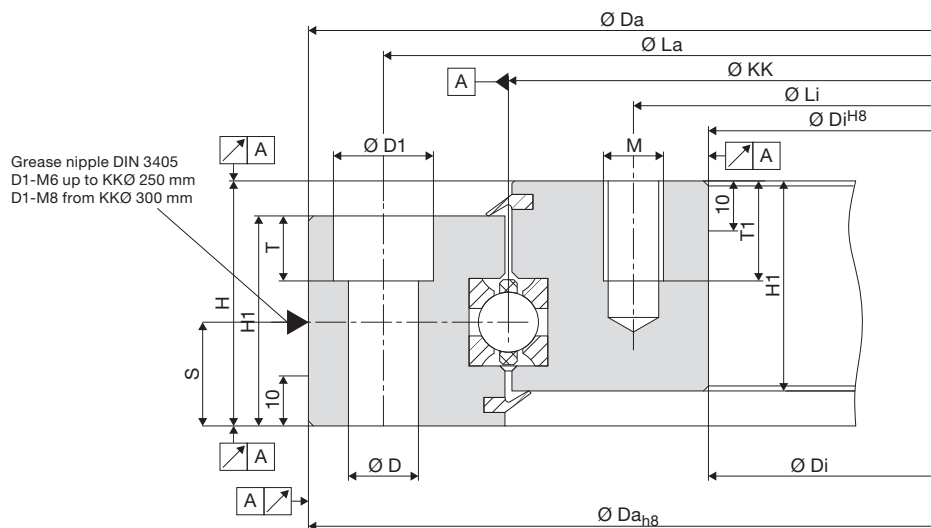

KKØ mm	Dimensions								
	D1	D	H	H1	M	S	T	T1	
100–250	11	6.6	34 <sup>+/-0.4</sup>	27	M 6	16,5	6,8	10	
300–350	15	9.0	38 <sup>+/-0.4</sup>	31	M 8	17,5	9,0	15	
400–450	18	11.0	44 <sup>+/-0.5</sup>	37	M 10	19,5	11,0	15	
500–600	20	14.0	49 <sup>+/-0.5</sup>	42	M 12	20,5	13,0	20	
700–1000	20	14.0	53 <sup>+/-0.5</sup>	45	M 12	21,5	13,0	20	
1200–1400	26	18.0	60 <sup>+/-0.5</sup>	52	M 16	33,5	17,5	25	
1600–1800	26	18.0	90 <sup>+/-0.5</sup>	82	M 16	48,5	17,5	25	

KKØ mm	Dimensions				Fixing/ mounting per ring	Load rating				Stat. moment kNm	Weight kg	Availability
	Da <sub>H8</sub>	Di <sup>H8</sup>	La	Li		kN						
					C <sub>0a</sub>	C <sub>0r</sub>	C <sub>a</sub>	C <sub>r</sub>	C <sub>0m</sub>			
LVA0100	150	50	135	65	6x	54	25	18	16	1	3.0	from stores
LVA0150	200	100	185	115	6x	82	39	22	19	3	4.6	from stores
LVA0200	250	150	235	165	8x	110	52	24	21	5	6.1	from stores
LVA0250	300	200	285	215	10x	138	65	26	23	8	7.6	from stores
LVA0300	360	240	340	260	12x	166	78	28	24	12	12.8	from stores
LVA0350	410	290	390	310	14x	196	92	30	26	16	15.0	
LVA0400	470	330	445	355	14x	424	199	54	47	40	23.7	from stores
LVA0450	520	380	495	405	14x	477	224	57	49	57	26.7	
LVA0500	580	420	550	450	14x	530	249	59	51	62	39.1	from stores
LVA0600	680	520	650	550	16x	635	299	63	54	63	46.9	from stores
LVA0700	790	610	750	650	22x	746	351	67	58	123	66.5	
LVA0800	890	710	850	750	24x	852	401	70	61	160	76.0	
LVA0900	990	810	950	850	24x	958	451	73	63	203	85.6	
LVA1000	1090	910	1050	950	26x	1068	503	76	66	251	95.0	
LVA1200	1300	1100	1265	1135	30x	1573	740	98	85	444	114.8	
LVA1400	1500	1300	1465	1335	36x	1835	864	104	90	604	169.0	
LVA1600	1730	1470	1685	1515	42x	2105	991	109	95	793	399.0	
LVA1800	1930	1670	1885	1715	46x	2367	1114	114	99	1003	449.0	

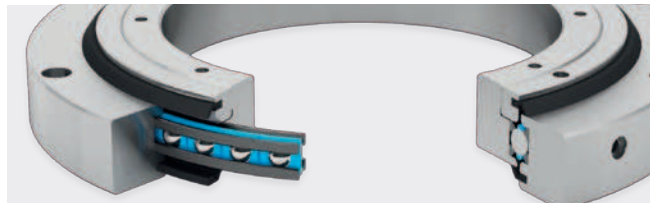

### Bearing type

LVA is a bearing assembly with housing rings made of steel and integrated bearing element. Franke bearing assemblies in type LVA are designed for medium rotational speeds and accuracies. They are available on short notice, in some cases even from the warehouse (see table).

### Characteristics

Franke bearing assemblies type LVA are ready-to-use, complete bearings with integrated Wire Race Bearings. Designed as 4-point bearings, they absorb equal load from all sides and are insensitive to impact and vibration. The bearing assemblies are sealed on both sides and set free from clearance and are preloaded. On request you can receive the bearing assemblies ex works with your specified preload values.

Please find construction examples, special accuracies and other options of individual tailoring on pages 11–19.

### Technical details

<b>Material</b>	Inner/outer ring: C45N, ball race rings: 54SiCr6, rolling element: 100Cr6, cage: PA12, seal: NBR
<b>Temperature in use</b>	-30 °C to +80 °C, briefly up to +100 °C
<b>Circumferential speed</b>	max. 5 m/s, without seals max. 10 m/s
<b>Screw connection</b>	See 'Technical information'.
<b>Lubricant grease</b>	Klüber ISOFLEX TOPAS NCA52
<b>Relubrication</b>	using grease nipples according to DIN 3405
<b>Lubrication schedule</b>	See 'Technical information'.



### Technical information/calculation

Please find additional information on bearing selection, calculation, mounting and setting in 'Technical information'. Our technical consultants are pleased to assist you in identifying the correct bearing assembly for your application.

Please call us under: +49 7361 920-0 or send us an email at: [info@franke-gmbh.de](mailto:info@franke-gmbh.de).

### Rotational resistance

The rotational resistance indicates the preload on the bearing assembly. It is dependent on the respective type and the race ring diameter. The values indicated in the diagram are standard values and can be aligned individually.

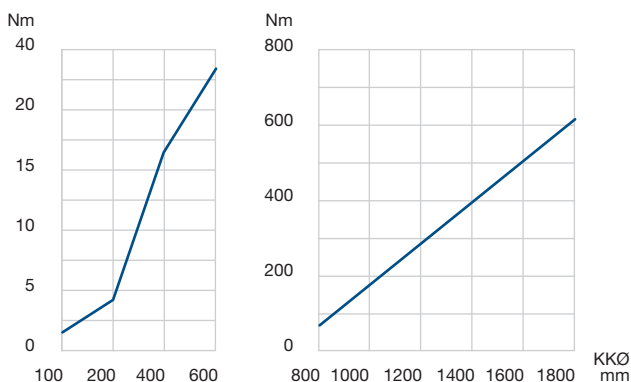

### Radial and axial runout accuracy

The running accuracies in the diagram are maximum values.

